

ProAction Thrust LP



ProAction Thrust LP



EN
Certification

ProAction Thrust LP

This floor system utilizes our ProAction Natural Rubber pads with two layers of plywood for dimensional stability and high shock absorption. The high-performance ProAction Thrust LP Floor System is EN & FIBA certified and is an excellent choice for aerobics, middle school and elementary school applications.

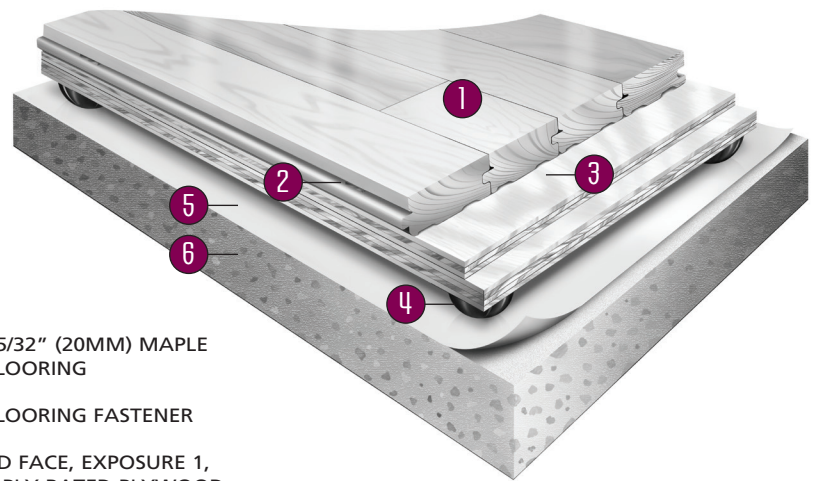

- 1 25/32" (20MM) MAPLE FLOORING
- 2 FLOORING FASTENER
- 3 CD FACE, EXPOSURE 1, 4-PLY RATED PLYWOOD
- 4 PROACTION 5/8" (16MM) PADS
- 5 6-MIL VAPOR RETARDER
- 6 CONCRETE SLAB

Slab depression for 25/32" (20mm) and 33/32" (27mm) shall be 2-1/4" (57mm) and 2-1/2" (64mm) respectively.

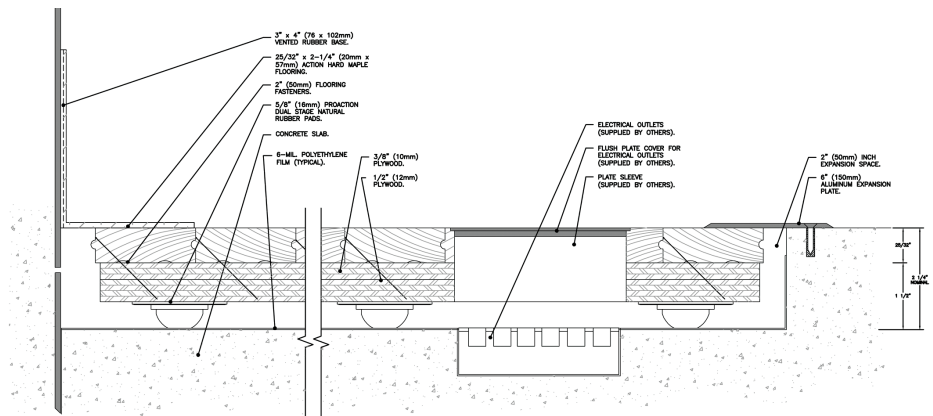

Action Floor Systems' sales, technical, manufacturing and customer service departments are located at our mill site in Mercer, Wisconsin, in the heart of the hardwood timber stands of Northern Wisconsin and Upper Michigan. Our short growing season is known for producing hard, dense timber with exceptional color uniformity.

We emphasize quality control in the production of our products and closely supervise warehousing, shipping and

order processing. We continually work with our installing dealers and their craftsmen to ensure a timely and defect-free installation of your Action Floor System.

All Action Floor Systems are designed to maximize performance, stability, longevity and safety, with cost-effectiveness. Please call, write or visit our website for further information on other Action Floor Systems.

Action Floor Systems, LLC has been a member of MFMA (Maple Flooring Manufacturers Association) since 1988. MFMA

maintains and continues to improve upon grading, milling and packaging standards to assure overall maximum quality and value of maple flooring.

It is the policy of Action Floor Systems, LLC to continuously update and improve our product lines. Therefore, we reserve the right to change, modify or discontinue systems, specifications and accessories of all products at any time without any notice or obligation to any purchasers.



1.01 DESCRIPTION

A. Related Sections: Cast-in-Place Concrete.

1. The general contractor shall provide a level slab, steel troweled to a tolerance of 1/8" (3mm) in a 10'0" (3m) radius and subject to the approval of the wood floor contractor.
2. Moisture barriers must be adequate for conditions.
3. MFMA does not acknowledge the use of FF/FL numbers to measure levelness/flatness tolerances in gymnasium concrete slabs.
4. Concrete shall not use river gravel or pea gravel and have an average of 3500 psi. compressive strength. Concrete must be cured for 60 days before installation can begin.
5. The concrete slab shall be depressed: 2-1/4" (57mm) for 25/32" (20mm) flooring.

1.02 QUALITY ASSURANCE

A. All system component parts must be supplied by Action Floor Systems, LLC.

- B. Manufacturer shall be an established firm experienced in field and have been in business a minimum of ten (10) years; Action Floor Systems, LLC or an approved equal.
- C. Manufacturer shall be solvent with no bankruptcy proceedings the previous seven (7) years.
- D. The flooring contractor must be approved by Action Floor Systems, LLC.
- E. Flooring system shall be independently tested and meets or exceeds athletic performance requirements for EN 14904. Independent testing laboratory shall have Scientific Body Membership in the International Association of Sports Surface Sciences (ISSS).
- F. Flooring system shall be independently verified to meet or exceed the SCORES criteria for environmental design and athletic performance: Sustainable Construction of Renewable Engineered Surfaces.

1.03 SUBMITTALS

- A. Manufacturers product data: Submit the ProAction Thrust LP specification sheets.
- B. Samples: Submit one (1) sample of the ProAction Thrust LP if requested by architect.
- C. Maintenance literature: Submit one (1) copy of manufacturer's maintenance instructions.

1.04 WORKING CONDITIONS

- A. Flooring materials must be allowed to acclimate to building conditions on the job site in a dry, well-ventilated area, not in contact with masonry, and shall be installed at a moisture content not to exceed 8% except in areas of constant high humidity where the moisture content of the flooring shall not exceed 10%.
- B. The wood flooring shall not be installed until all masonry, plastering, tile, marble and terrazzo work is completed, and overhead mechanical trades and painters have finished in wood floor area. The building must be reasonably dry; all openings must be closed in; permanent heating and air conditioning installed and operating.
- C. The concrete slab shall be dry, free of foreign materials, and turned over to the wood flooring contractor broom clean. Moderate room temperature of 65 degrees (18 C) or more shall be maintained a week preceding and throughout the duration of the work. Humidity conditions within the building shall approximate humidity conditions which will prevail when the building is occupied. Care should be taken to maintain humidity within the range of 35% to 50%.

1.05 WARRANTY

- A. Action Floor Systems, LLC warrants the material it ships to be free from defects in materials and workmanship for a period of one year and the flooring installer warrants the installation of the flooring to be free of defects in materials and workmanship for a period of one year. The exclusive remedy under this warranty shall be replacement of defective material supplied by Action Floor Systems, LLC or correction of defective installation by the flooring installer. All implied warranties of merchantability or fitness for intended use are limited to the period of this warranty. This warranty excludes consequential damages.
- B. This warranty does not cover damage caused by fire, winds, floods, chemicals, or other abuse, or by failure of other contractors to adhere to specifications, or neglect of reasonable precaution to provide adequate ventilation during hot and humid weather. This warranty also excludes damage due to excessive dryness or excessive moisture from humidity, spillage, migration through the slab or wall or any other source. This warranty also excludes damage to floors due to ordinary wear and tear, faulty construction of the building, (other than the flooring installation), separation of the concrete slab underlying the floor, settlement of the walls, or use of water on the floor.
- C. During the warranty period, the floor cannot be coated without the permission of the floor contractor.

2.01 MATERIALS

A. Flooring

1. Flooring shall be Northern Hard Maple standard strip flooring, 25/32" x 2-1/4" (20mm x 57mm) or 1-1/2" (38mm), TGEM, MFMA grade marked & stamped as manufactured by Action Floor Systems, LLC.
2. Grades available are MFMA 1st, 2nd&Btr. 3rd&Btr. and 3rd grade.
3. Long Length Strip Flooring by Action Floor Systems, LLC. (optional).
4. FSC Certified Lumber (optional).

5. Expansion Ridge Technology (ERT) 1/64" milled expansion spacer (optional).

B. Subfloor

1. Vapor barrier shall be 6-mil polyethylene.
2. The pads shall be ProAction 5/8" (16mm) natural rubber pads.
3. Panels shall be 4' x 8' (1.2m x 2.4m) CD face exposure 1, rated plywood.

C. Fasteners

1. Subfloor fasteners shall be 3/4" (19mm) coated staples.
2. Flooring fasteners shall be 1-3/4" (44mm) cleats, or 15-gauge coated staples.

D. Wall Base

1. Wall base shall be 3" x 4" (76mm x 102mm) vented cove base with pre-molded corners (specify black or brown), as supplied by Action Floor Systems, LLC.

E. Protective Floor Cover (optional)

1. Action AirRide cover system with patented air blower system. System includes Phthalate-free, seamless 10'-0" wide, 20.5 ounce vinyl covers and A-frame rack.

3.01 INSPECTION

- A. Inspect concrete slab for proper tolerance and dryness reporting any discrepancies in writing to the general contractor.
- B. All work to put the concrete slab in acceptable condition shall be the responsibility of the general contractor.
- C. Slab shall be broom cleaned by the general contractor.

3.02 INSTALLATION

- A. Cover concrete slab with polyethylene, lapping edges 6" (150mm) and seal with adhesive or 2" (50mm) duct tape.
- B. ProAction pads shall be attached to the underside of the first layer of plywood as specified by the manufacturer.
- C. Place the first layer of plywood perpendicular to the intended direction of the finish flooring in a running bond pattern. Allow 1/4" (6mm) between panels at sides and edges, and a 2" (50mm) expansion void at walls and vertical obstructions.
- D. Fasten the second layer of plywood without pads in a running bond pattern. End joints and edge joints must be installed such that they overlap the supporting layer by 24" (0.6m). The plywood sheets must be nailed or stapled together with 3/4" (19mm) fasteners starting from the center of the sheet working outward. No joint in the second layer of plywood shall coincide with a joint in the first layer. Allow 1/4" (6mm) between panels at sides and edges, and a 2" (50mm) expansion void at walls and vertical obstructions on both sheets of plywood.
- E. Machine nail strip flooring into the plywood subfloor, parallel to the long dimension of the area nail approximately 12" (300mm) on-center. Provide adequate expansion at regular intervals across the floor during installation as dictated by the average humidity conditions of the area according to the recommendations of the local Action Floor Systems, LLC flooring contractor. Provide 2" (50mm) expansion voids at perimeter and all vertical obstructions. Install vent cove base over perimeter voids and metal thresholds at doorways.

3.03 FLOOR SANDING

- A. Use coarse, medium and fine grade sandpaper.
- B. After sanding, buff entire floor using 100-grit screen or equal grit sandpaper, with a heavy-duty buffing machine.
- C. Vacuum or tack floor before first coat of finish.
- D. Floor shall present a smooth surface without drum stop marks, gouges, streaks or shiners.

3.04 FINISHING

- A. Inspect entire area of floor to ensure that the surface is acceptable for finishing, completely free of sanding dust and perfectly clean.
- B. Apply seal and finish per manufacturer's instructions.
- C. Buff and vacuum or tack between each coat after it dries.
- D. Apply game lines accurately after the seal coat, after buffing and vacuuming. Lay out in accordance with drawings. For game lines, use current rules of association having jurisdiction. Lines shall be straight with sharp edges in colors selected by the architect. Game line paint shall be compatible with finish.

3.05 BASE INSTALLATION

- A. Affix rubber base to wall with recommended adhesive or screws. Miter all corners carefully. Use premolded outside corners. Install aluminum thresholds as required, anchoring firmly in concrete floor beyond limits of wood flooring.

3.06 CLEAN UP

- A. Clean up all unused materials and debris and remove from premises, properly dispose of all waste materials.

3.07 MAINTENANCE

- A. Upon completion of floor installation, the owners, attendants or individuals in charge and responsible for the upkeep of the building are to see that the care and maintenance instructions of the MFMA are followed. Failure to do so may void warranty.

ProAction Thrust LP

For technical assistance, custom specifications or matching a specification, contact us at:

ACTION FLOOR SYSTEMS LLC
4781 N. US HWY. 51
MERCER, WI 54547-9708 U.S.A.
PHONE: 800.746.3512 OR
715.476.3512
FAX: 715.476.3585
EMAIL: info@actionfloors.com

GO ONLINE FOR FLOOR SYSTEM SELECTIONS

www.actionfloors.com

We have dozens of Action floor system options to choose from, and we've made it easy for you to zero-in on the best fit for your project. Just visit our website and click on "Choose a Facility".

- Select the type of facility or activity that matches your project.
- Select the level of primary-usage performance characteristics your project requires.
- Compare the specifications of recommended floor options.
- View detailed, top-to-bottom cross-section illustrations of all floor systems.
- Download PDFs or CAD graphic files.



EN
Certification

Action Floor Systems LLC is FSC certified. © 1996 Forest Stewardship Council A.C. SW-COC-000796.