



ActionCush™ I Floor System

SYSTEM TYPE: FLOATING RESILIENT



Strong, stable, double layer 15/32" (12 mm) thick APA exposure 1 rated sheathing minimum APA span rating of 32/16

Action E-Cush 3/8" (10 mm) pad or optional 5/8" (16 mm) E-Cush pad



Option to specify Action Hardwood Premium Sheathing (HPS)

MFMA NORTHERN HARD MAPLE BY ACTION:

Random Length (RL)
Action Long Length (FJ)
Expansion Ridge Technology (ERT)

TESTING AGENCY:

Certified by ISSS

PERFORMANCE MEETS OR EXCEEDS:

IHF
WHF

SLAB DEPRESSION:

25/32" (20 mm): 2-1/8" (54 mm)
33/32" (27 mm): 2-3/8" (60 mm)

LEED:



FloorScore®-certified
Proprietary certified EPD®
FSC®-certified Maple and Subfloor available
MR credits – based on products, selected materials and facility locations

PERFORMANCE & SYSTEM STABILITY:

- Stable double layer 15/32" (12 mm) sheathing subfloor
- SCORES Compliant
- System features a low profile height
- Effective playability double layer sheathing system
- Uniform, predictable playing surface
- Contact Action for system variations to meet other slab or performance needs

- Delivers uniform surface, the floor system can be tuned to meet your performance expectations.
- Features the proven stability and playability of double layer 15/32" (12 mm) sheathing subfloor design.
- The manufacturer and flooring shall be independently verified by the guidelines of the ISO 14040:2006 and ISO 14044:2006 Life Cycle Assessment (LSA) confirming a negative carbon footprint.
- Carbon Evaluation must be inclusive and based on all corporate facilities, offices and mills.
- The manufacturer and flooring shall be independently verified by the guidelines of the ISO 14064-1:2006 World Resources Institute Greenhouse Gas Protocol, Scope 1, 2 and 3.
- The manufacturer and flooring shall be registered in the Collaborative for High Performance Schools (CHPS) Product Database.
- Floor system manufacturer must provide a Life Cycle Assessment and an Environmental Product Declaration (EPD®) in accordance with the Product Category Rule Version 2.2014.
- Floor system manufacturer must be FloorScore® Certified in accordance with CDPH 01350.

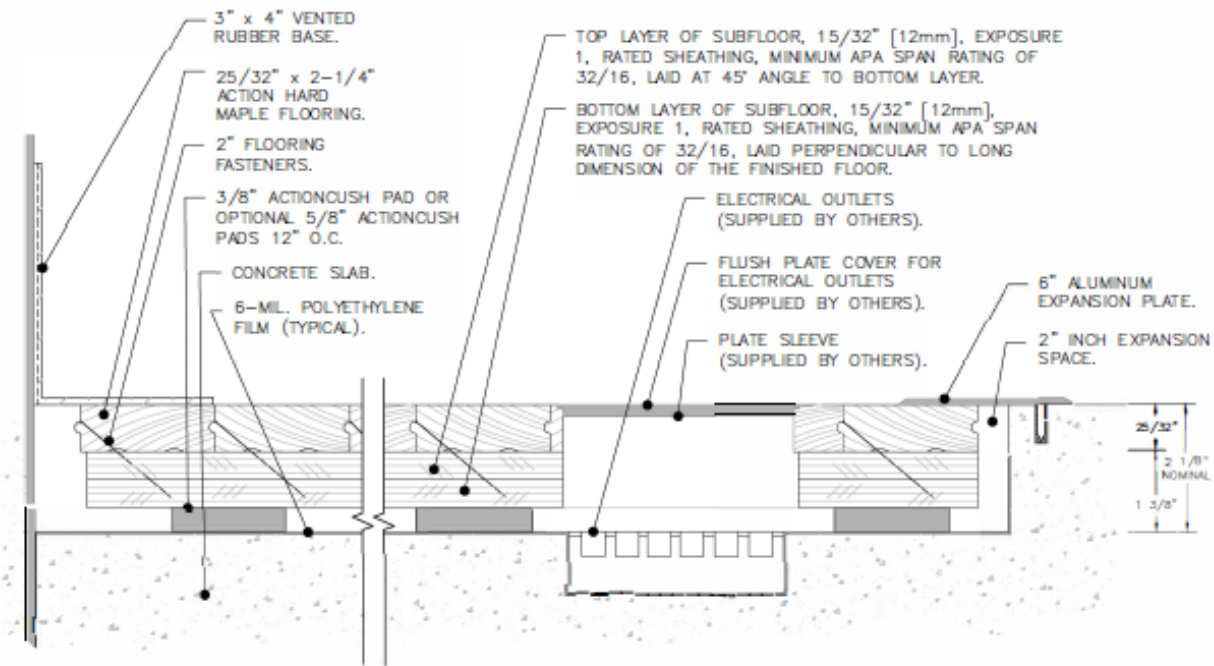

Complete product specifications and system drawings are available online at: www.actionfloors.com



ACTION FLOOR SYSTEMS, LLC
4781 N. US Hwy 51 • Mercer, WI 54547

TOLL FREE: 800-746-3512 • VOICE: 715-476-3512
FAX: 715-476-3585 • EMAIL: info@actionfloors.com

actionfloors.com

Rev 12/17