

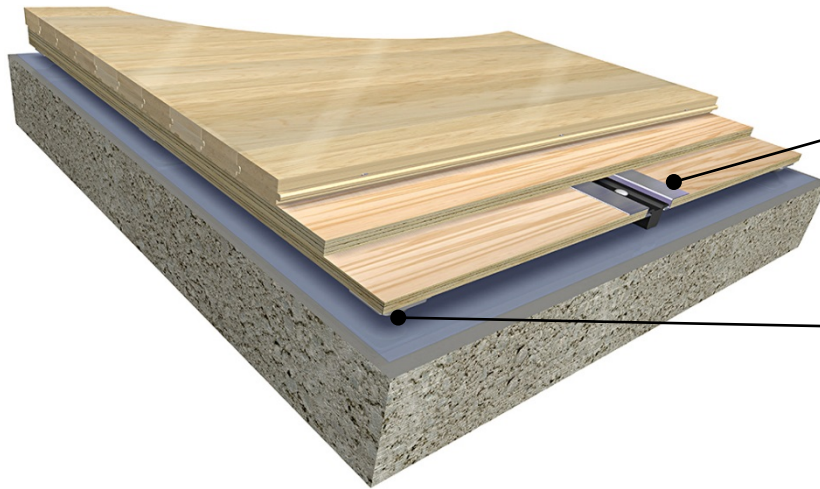

# ChannelFlex Ultra NR

SYSTEM TYPE: ANCHORED RESILIENT



Factory fabricated subfloor system featuring steel stabilizing Z-channels anchored by polymer retention blocks for exceptional performance and stability.

Action 5/8" (16 mm) ProAction dual stage natural rubber performance pads.

**MFMA Northern Hard Maple by Action:**

Random Length (RL)  
Action Long Length (FJ)  
Action Expansion Ridge Technology (ER)

**Testing Agency:**

Certified by ISSS

**Performance Meets or Exceeds:**

MFMA PUR  
EN 14904 Type 4  
DIN 18032 Part 2  
ASTM F2772 MFMA PUR  
FIBA Level 1

**Slab Depression:**

25/32" (20 mm): 2-1/4" (57 mm)  
33/32" (27 mm): 2-1/2" (64 mm)

**LEED:**



FloorScore®-certified  
Proprietary certified EPD®  
FSC-certified Maple and Subfloor available  
MR credits – based on products, selected materials and facility locations

**Performance and System Stability:**

- Anchored resilient design for stability
- Excellent athletic playability
  - Excellent shock absorption
  - Factory fabricated subfloor for superior consistency
  - SCORES\* compliant

\* Sustainable Construction Of Renewable Engineered Surfaces. Action has been certified as a Carbon Negative provider following a Life Cycle Assessment conducted by the University of Wisconsin and Carbon Clear, an international independent auditor of manufacturing carbon profiles.



- Factory fabricated subfloors provide a superior level of uniformity.
- Engineered to deliver outstanding playability and performance while minimizing unwanted vibration/energy transfer to the athlete.
- The manufacturer and flooring shall be independently verified by the guidelines of the ISO 14040-2006 and ISO 14044: #2006 Life Cycle Assessment (LSA) confirming a negative carbon footprint.
- Carbon Evaluation must be inclusive and based on all corporate facilities, offices and mills.
- The manufacturer and flooring shall be independently verified by the guidelines of the ISO 14064-1:2006 World Resource Institutes Greenhouse Gas Protocol, Scope 1, 2 and 3.
- The manufacturer and flooring shall be registered in the Collaborative for High Performance Schools (CHPS) Product Database.
- Floor system manufacturer must provide a Life Cycle Assessment and an Environmental Product Declaration (EPD) in accordance with the Product Category Rule Version 2.2014.
- Floor system manufacturer must be FloorScore Certified in accordance with CDPH 01350.

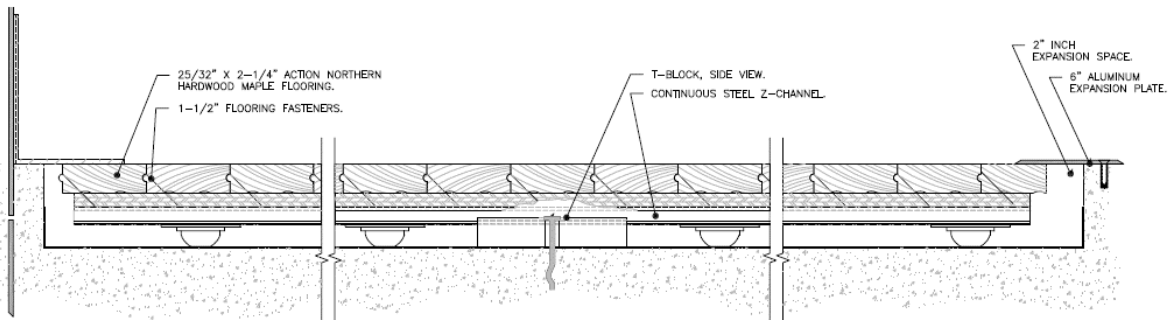

Action\_ChannelFlex\_NR1  
Section across room width

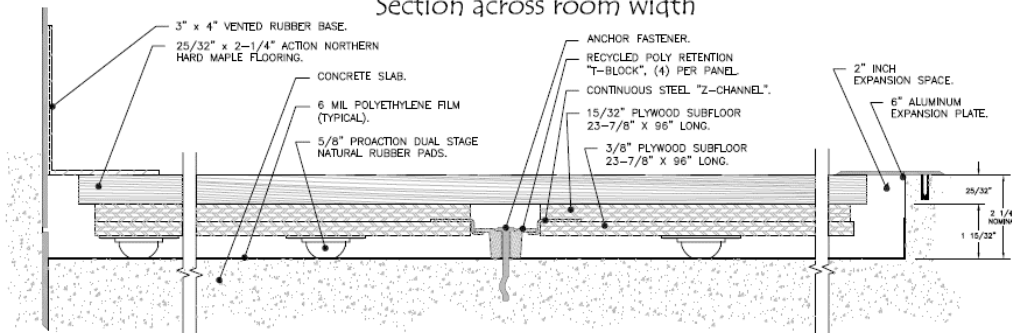

Complete product specifications and system drawings are available online at: [www.actionfloors.com](http://www.actionfloors.com)



ACTION FLOOR SYSTEMS, LLC  
 4781 N. US Hwy 51 • Mercer, WI 54547  
 TOLL FREE: 800-746-3512 • VOICE: 715-476-3512  
 FAX: 715-476-3585 • EMAIL: [info@actionfloors.com](mailto:info@actionfloors.com)  
[actionfloors.com](http://actionfloors.com)

REV 12/17