

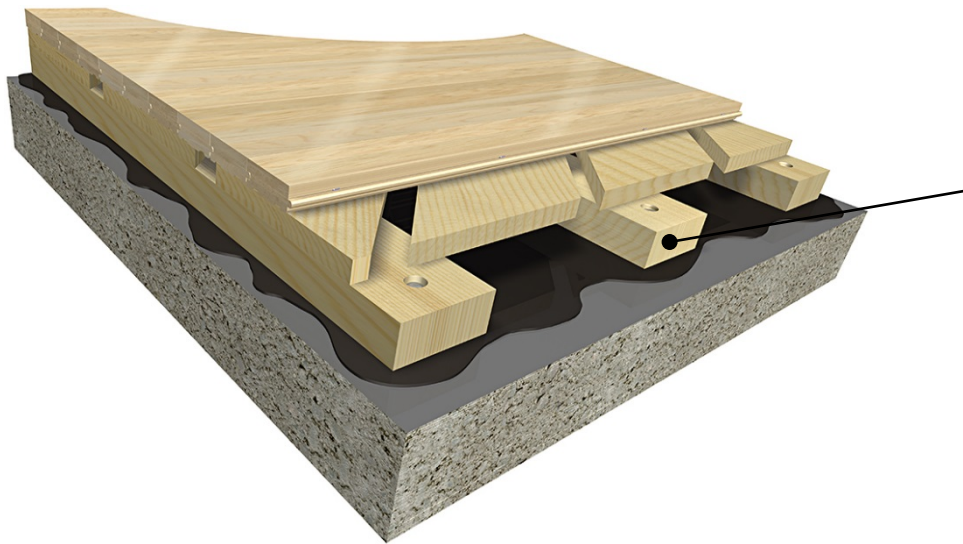

# Action Fixed Sleeper™ Floor System

SYSTEM TYPE: FIXED



*Anchored sleepers with 1x6 pine subfloor to give excellent dimensional stability*

**MFMA NORTHERN HARD MAPLE BY ACTION:**

Random Length (RL)  
Action Long Length (FJ)  
Expansion Ridge Technology (ERT)

**TESTING AGENCY:**

Certified by ISSS

**PERFORMANCE MEETS OR EXCEEDS:**

**SLAB DEPRESSION:**

25/32" (20 mm): 3-3/8" (86 mm)  
33/32" (27 mm): 3-5/8" (92 mm)

**LEED:**



FloorScore®-certified  
Proprietary certified EPD®  
FSC®-certified Maple and Subfloor available  
MR credits – based on products, selected materials and facility locations

**PERFORMANCE AND SYSTEM STABILITY:**

- Anchored sleeper design
- Excellent ball bounce
  - SCORES Compliant
  - System features a high profile height
  - Anchored design minimizes potential dead spots
  - System features retained laminated sleepers with continuous subfloor sheathing
  - Contact Action for system variations to meet other slab or performance needs



- Delivers uniform surface, the floor system can be tuned to meet your performance expectations.
- Features the playability of laminated sleepers with a layer of solid wood for structural support.
- The manufacturer and flooring shall be independently verified by the guidelines of the ISO 14040:2006 and ISO 14044:2006 Life Cycle Assessment (LSA) confirming a negative carbon footprint.
- Carbon Evaluation must be inclusive and based on all corporate facilities, offices and mills.
- The manufacturer and flooring shall be independently verified by the guidelines of the ISO 14064-1:2006 World Resources Institute Greenhouse Gas Protocol, Scope 1, 2 and 3.
- The manufacturer and flooring shall be registered in the Collaborative for High Performance Schools (CHPS) Product Database.
- Floor system manufacturer must provide a Life Cycle Assessment and an Environmental Product Declaration (EPD®) in accordance with the Product Category Rule Version 2.2014.
- Floor system manufacturer must be FloorScore® Certified in accordance with CDPH 01350.

25) ACTION FIXED-SLEEPER SIDE VIEW

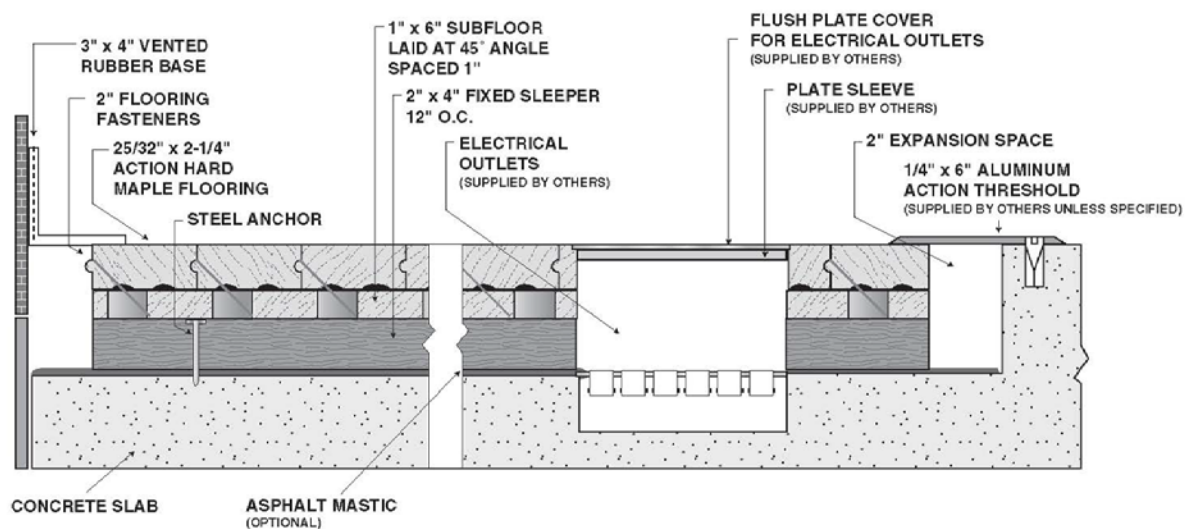

Complete product specifications and system drawings are available online at: [www.actionfloors.com](http://www.actionfloors.com)



ACTION FLOOR SYSTEMS, LLC  
 4781 N. US Hwy 51 • Mercer, WI 54547  
 TOLL FREE: 800-746-3512 • VOICE: 715-476-3512  
 FAX: 715-476-3585 • EMAIL: [info@actionfloors.com](mailto:info@actionfloors.com)  
[actionfloors.com](http://actionfloors.com)

Rev 12/17