

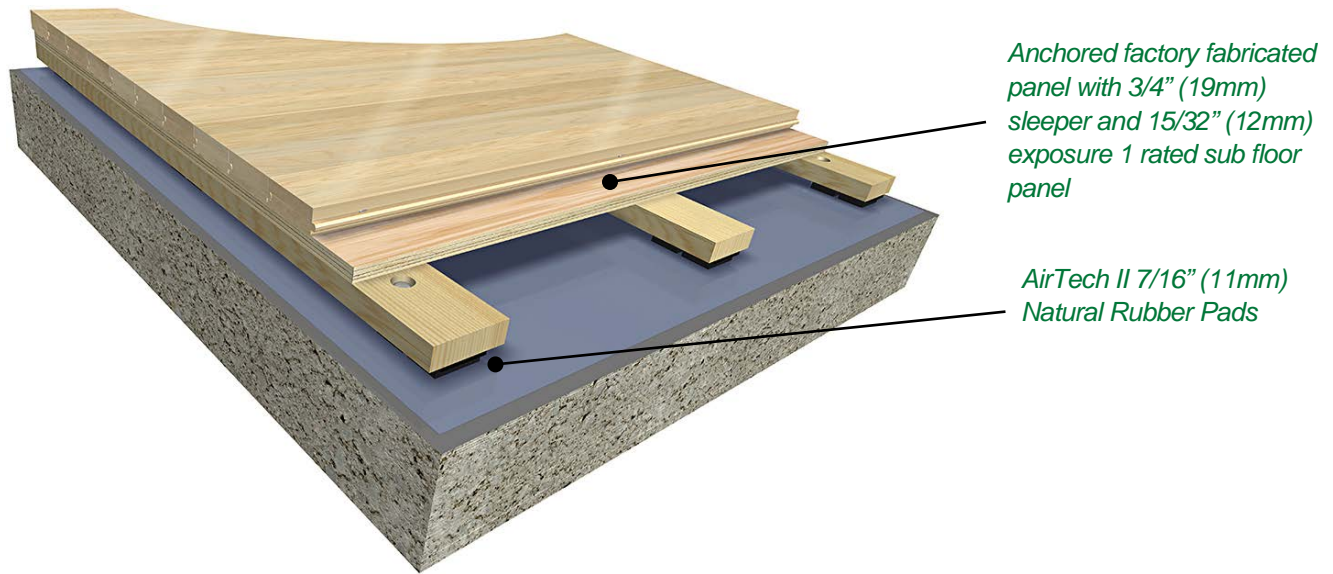

# Concorde I

SYSTEM TYPE: ANCHORED RESILIENT



Anchored factory fabricated panel with 3/4" (19mm) sleeper and 15/32" (12mm) exposure 1 rated sub floor panel

AirTech II 7/16" (11mm) Natural Rubber Pads

**MFMA NORTHERN HARD MAPLE BY ACTION:**

Random Length (RL)  
Action Long Length (FJ)  
Expansion Ridge Technology (ERT)

**TESTING AGENCY:**

Certified by ISSS

**PERFORMANCE MEETS OR EXCEEDS:**

**SLAB DEPRESSION:**

25/32" (20 mm): 2-3/8" (60 mm)  
33/32" (27 mm): 2-5/8" (67 mm)

**LEED:**



FloorScore®-certified  
Proprietary certified EPD®  
FSC®-certified Maple and Subfloor available  
MR credits – based on products, selected materials and facility locations

**PERFORMANCE AND SYSTEM STABILITY:**

- Factory fabricated subfloor system
- Superior stability and strength
- Ideal renovation system
- Excellent shock absorption

- Concorde I is highly resilient, has uniform playability and consistent shock absorption to maximize the athletes comfort and performance.
- Factory fabricated panels and natural rubber pads maximize the products' uniformity and consistency.
- The manufacturer and flooring shall be independently verified by the guidelines of the ISO 14040:2006 and ISO 14044:2006 Life Cycle Assessment (LSA) confirming a negative carbon footprint.
- Carbon Evaluation must be inclusive and based on all corporate facilities, offices and mills.
- The manufacturer and flooring shall be independently verified by the guidelines of the ISO 14040-2006 World Resources Institute Greenhouse Gas Protocol, Scope 1, 2 and 3.
- The manufacturer and flooring shall be registered in the Collaborative for High Performance Schools (CHPS) Product Database.
- Floor system manufacturer must provide a Life Cycle Assessment and an Environmental Product Declaration (EPD®) in accordance with the Product Category Rule Version 2.2014.
- Floor system manufacturer must be FloorScore® Certified in accordance with CDPH 01350.

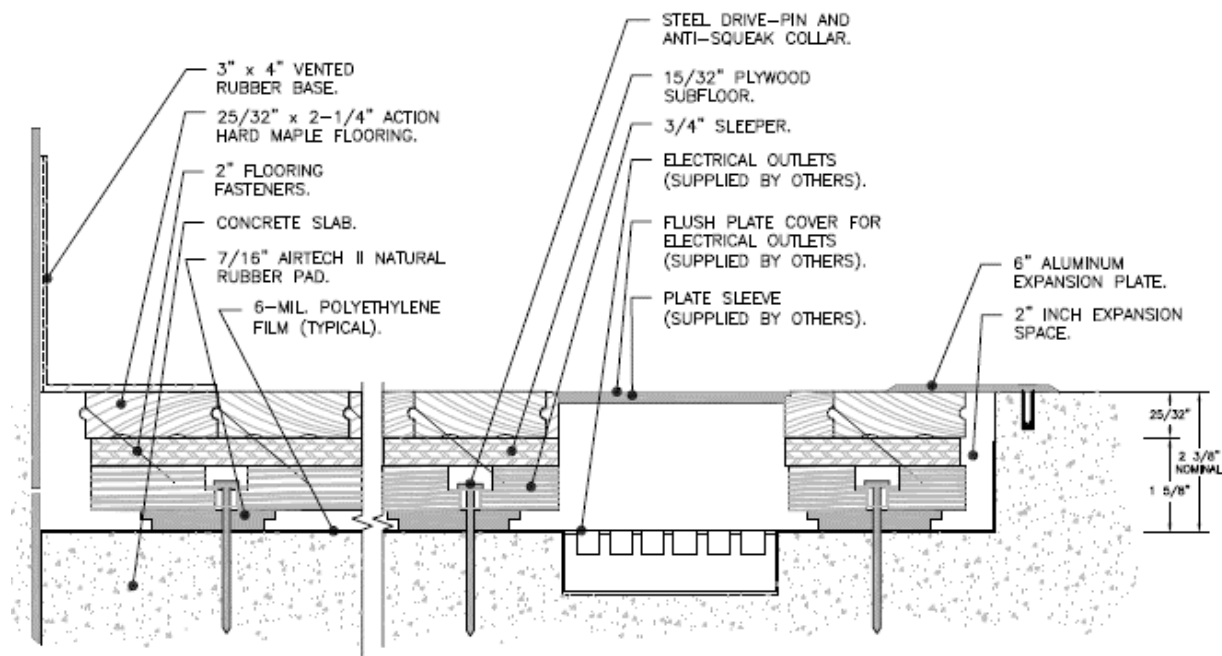

Complete product specifications and system drawings are available online at: [www.actionfloors.com](http://www.actionfloors.com)



ACTION FLOOR SYSTEMS, LLC  
 4781 N. US Hwy 51 • Mercer, WI 54547  
 TOLL FREE: 800-746-3512 • VOICE: 715-476-3512  
 FAX: 715-476-3585 • EMAIL: [info@actionfloors.com](mailto:info@actionfloors.com)  
[actionfloors.com](http://actionfloors.com)