



Atelier Ultra

SYSTEM TYPE: ANCHORED RESILIENT



Factory fabricated subfloor system provides maximum vibration control.

Polymer "T" blocks positively retain the floor system while allowing unencumbered vertical deflection.

Continuous foam isolation ribbons combined with supple natural rubber pads offer the optimum in performance, uniformity, and vibration dampening.

MFMA NORTHERN HARD MAPLE BY ACTION:

Random Length (RL)
Action Long Length (FJ)
Expansion Ridge Technology (ERT)

TESTING AGENCY:

Certified by ISSS

PERFORMANCE MEETS OR EXCEEDS:

ANSI E1.26-2006 (R2012)
DIN 18032 Part 2 (1991 & 2001)
EN 14904 Type 4 Certified
ASTM F2772

SLAB DEPRESSION:

2-9/16" (65 mm) Depression using 25/32" (20 mm) maple

LEED:



FloorScore®-certified
Proprietary certified EPD®
FSC®-certified Maple and Subfloor available
MR credits – based on products, selected materials and facility locations

PERFORMANCE AND SYSTEM STABILITY:

- Factory fabricated subfloor system
- Superior stability and strength
 - System design can provide solid blocking characteristic
 - Anchored system confirms uniform performance

- Action Atelier Floor system is ANSI E1.26-2006 (R2012) and EN Certified providing great ball response and uniform playability to maximize the athletes comfort and performance.
- Factory fabricated subfloor system and resilient layer with vibration control and performance features for the needs of the dancers.
- The manufacturer and flooring shall be independently verified by the guidelines of the ISO 14040:2006 and ISO 14044:2006 Life Cycle Assessment (LSA) confirming a negative carbon footprint.
- Carbon Evaluation must be inclusive and based on all corporate facilities, offices and mills.
- The manufacturer and flooring shall be independently verified by the guidelines of the ISO 14040-2006 World Resources Institute Greenhouse Gas Protocol, Scope 1, 2 and 3.
- The manufacturer and flooring shall be registered in the Collaborative for High Performance Schools (CHPS) Product Database.
- Floor system manufacturer must provide a Life Cycle Assessment and an Environmental Product Declaration (EPD®) in accordance with the Product Category Rule Version 2.2014.
- Floor system manufacturer must be FloorScore® Certified in accordance with CDPH 01350.

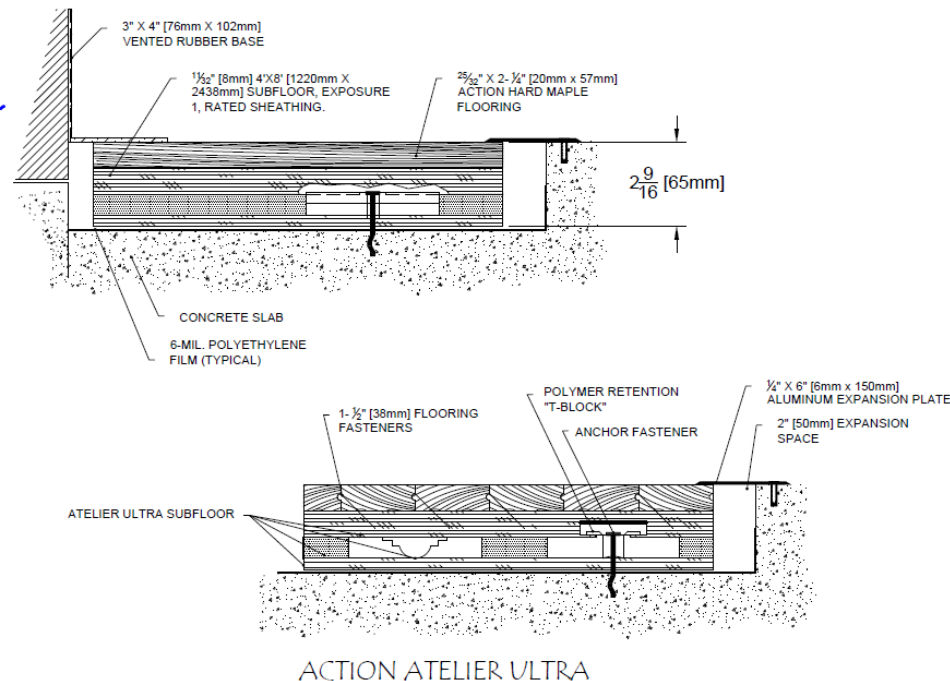

Complete product specifications and system drawings are available online at: www.actionfloors.com



ACTION FLOOR SYSTEMS, LLC
 4781 N. US Hwy 51 • Mercer, WI 54547
 TOLL FREE: 800-746-3512 • VOICE: 715-476-3512
 FAX: 715-476-3585 • EMAIL: info@actionfloors.com
actionfloors.com

Rev 11/20