



Zone One

SYSTEM TYPE: ANCHORED RESILIENT



Factory Fabricated subfloor system provides maximum vibration control.

Recycled polymer retention "T" block with positive anchoring allows for vertical athletic deflection and horizontal expansion movement.

Continuous 5/8" strip foam combined with all-natural rubber pads provide optimum ball rebound and vibration dampening.

MFMA NORTHERN HARD MAPLE BY ACTION:	Random Length (RL) Action Long Length (FJ) Expansion Ridge Technology (ERT)
TESTING AGENCY:	Certified by ISSS
PERFORMANCE MEETS OR EXCEEDS:	MFMA PUR EN 14904 Type 4 Certified DIN 18032-2 (2001) ASTM F2772
SLAB DEPRESSION:	2-9/16" (65 mm) Slab Depression using 25/32" flooring
LEED:	FloorScore®-certified Proprietary certified EPD® FSC®-certified Maple and Subfloor available MR credits – based on products, selected materials and facility locations
PERFORMANCE AND SYSTEM STABILITY:	Factory fabricated subfloor system <ul style="list-style-type: none"> • Superior stability and strength • System design can provide solid blocking • Anchored system confirms uniform performance

- Zone One Floor system is PUR and EN Certified providing great ball response and uniform playability to maximize the athletes comfort safety and performance.
- Factory fabricated subfloor system and resilient layer provides strength and stability while allowing consistent airflow throughout the sub floor.
- The manufacturer and flooring shall be independently verified by the guidelines of the ISO 14040:2006 and ISO 14044:2006 Life Cycle Assessment (LSA) confirming a negative carbon footprint.
- Carbon Evaluation must be inclusive and based on all corporate facilities, offices and mills.
- The manufacturer and flooring shall be independently verified by the guidelines of the ISO 14040-2006 World Resources Institute Greenhouse Gas Protocol, Scope 1, 2 and 3.
- The manufacturer and flooring shall be registered in the Collaborative for High Performance Schools (CHPS) Product Database.
- Floor system manufacturer must provide a Life Cycle Assessment and an Environmental Product Declaration (EPD®) in accordance with the Product Category Rule Version 2.2014.
- Floor system manufacturer must be FloorScore® Certified in accordance with CDPH 01350.

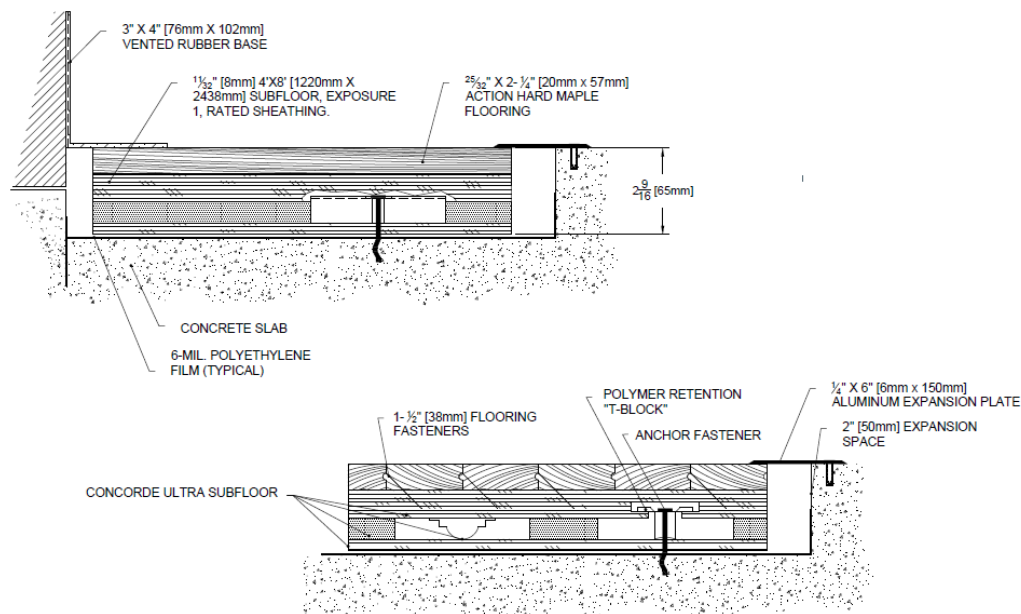

Complete product specifications and system drawings are available online at: www.actionfloors.com



ACTION FLOOR SYSTEMS, LLC
 4781 N. US Hwy 51 • Mercer, WI 54547
 TOLL FREE: 800-746-3512 • VOICE: 715-476-3512
 FAX: 715-476-3585 • EMAIL: info@actionfloors.com
actionfloors.com

Rev 6/21