



# ZoneOne LP

SYSTEM TYPE: ANCHORED RESILIENT



Factory Fabricated subfloor system provides maximum vibration control.

Recycled polymer retention "T" block with positive anchoring allows for vertical athletic deflection and horizontal expansion movement.

Continuous 5/8" strip foam combined with all-natural rubber pads provide optimum ball rebound and vibration dampening.

**MFMA NORTHERN HARD MAPLE BY ACTION:**

Random Length (RL)  
Expansion Ridge Technology (ERT)

**TESTING AGENCY:**

Certified by ISSS

**PERFORMANCE MEETS OR EXCEEDS:**

MFMA PUR Compliant  
EN 14904 Type 4 Certified  
DIN 18032-2 (2001)  
ASTM F2772

**SLAB DEPRESSION:**

2-3/16" (56 mm) Slab Depression using 25/32" flooring

**LEED:**



FloorScore®-certified  
Proprietary certified EPD®  
FSC®-certified Maple and Subfloor available  
MR credits – based on products, selected materials and facility locations

**PERFORMANCE AND SYSTEM STABILITY:**

Factory fabricated subfloor system

- Superior stability and strength
- System design can provide solid blocking
- Anchored system confirms uniform performance

- Action ZoneOne LP floor system is MFMA PUR Compliant and DIN Certified providing great ball response and uniform playability to maximize the athletes comfort safety and performance.
- Factory fabricated subfloor system and resilient layer providing strength and stability while allowing consistent airflow throughout the sub floor.
- The manufacturer and flooring shall be independently verified by the guidelines of the ISO 14040:2006 and ISO 14044:2006 Life Cycle Assessment (LSA) confirming a negative carbon footprint.
- Carbon Evaluation must be inclusive and based on all corporate facilities, offices and mills.
- The manufacturer and flooring shall be independently verified by the guidelines of the ISO 14040-2006 World Resources Institute Greenhouse Gas Protocol, Scope 1, 2 and 3.
- The manufacturer and flooring shall be registered in the Collaborative for High Performance Schools (CHPS) Product Database.
- Floor system manufacturer must provide a Life Cycle Assessment and an Environmental Product Declaration (EPD®) in accordance with the Product Category Rule Version 2.2014.
- Floor system manufacturer must be FloorScore® Certified in accordance with CDPH 01350.

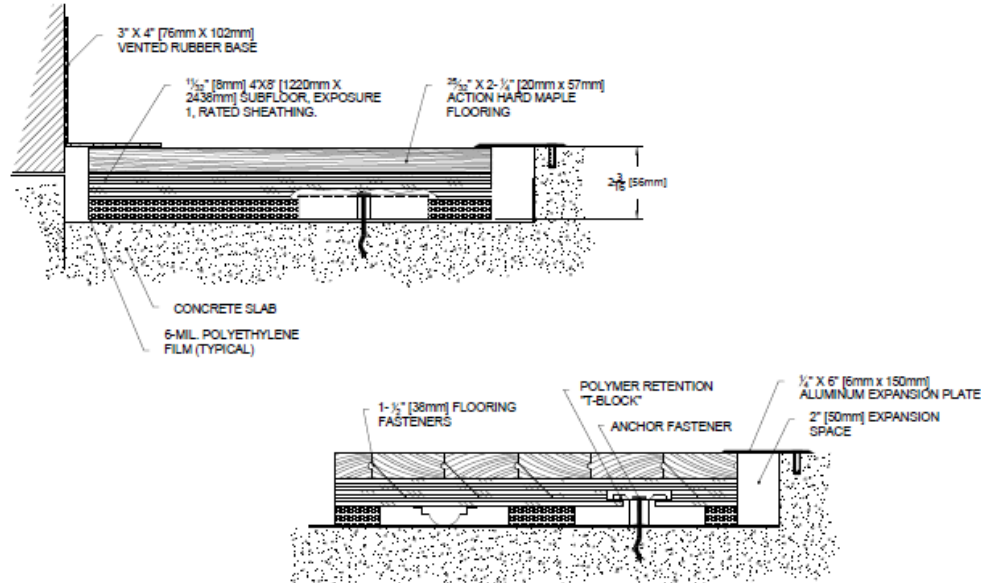

Complete product specifications and system drawings are available online at: [www.actionfloors.com](http://www.actionfloors.com)



ACTION FLOOR SYSTEMS, LLC  
 4781 N. US Hwy 51 • Mercer, WI 54547  
 TOLL FREE: 800-746-3512 • VOICE: 715-476-3512  
 FAX: 715-476-3585 • EMAIL: [info@actionfloors.com](mailto:info@actionfloors.com)  
[actionfloors.com](http://actionfloors.com)

Rev